

FACILITY TECHNICAL INFORMATION

(Updated March 2013)

GENERAL INFORMATION:

TELEPHONE NUMBERS

Administrative Offices	772-220-1942
Administrative Offices – FAX	772-287-8693
Box Office	772-286-7827
Box Office – FAX	772-283-2374

FOR SHOW ADVANCE:

Bert Zimmerman - Production & Hospitality Advance Bert@lyrictheatre.com	772-260-7343
--	--------------

LYRIC STAFF:

John Loesser – Executive Director loesserj@hotmail.com	772-201-5847
Kia Hamill – Assistant Executive Director kia@lyrictheatre.com	772-220-1942, ext. 207
Bert Zimmerman – Production & Technical Director thalm1020@yahoo.com	772-260-7343
Polly Delater – Director of Box Office Services boxoffice@lyrictheatre.com	772-220-1942, ext. 204

DRIVING DIRECTIONS

FROM 95 GOING SOUTH:

- Take the first Stuart Exit #62 (old number). Make a left turn onto Hwy 714.
- Make a left turn onto Martin Downs Blvd. The turnpike entrance will be on your right.
- Continue on Martin Downs Blvd approx 3 miles. Cross over Palm City Bridge.
- At light turn left onto Kanner Hwy (also called Hwy 76). A Hess Gas Station will be on your right.
- Continue on Kanner which turns into Colorado when you cross. U.S. Hwy 1.
- After crossing US 1, continue straight, move into the left lane when possible.
- Approx 1 mile you'll come to **Confusion Corner**. *You'll know that you are there because you'll be confused!* This is a traffic circle. Drive counterclockwise and turn right onto Flagler Ave. before you cross over the tracks again.
- Keeping the tracks on your left, drive north on Flagler.
- The Lyric Theatre is near the end of the block on your right.

There is additional parking across the tracks in the lot by Sailfish circle.

FROM 95 GOING NORTH:

- Take the first Stuart Exit #101 (old number 61)
- Turn right onto Hwy 76
- Proceed approx. 7 miles to **Confusion Corner**. *You'll know that you are there because you'll be confused!* This is a traffic circle. Drive counterclockwise and turn right onto Flagler Ave. before you cross over the tracks again.
- Keeping the tracks on your left, drive north on Flagler.
- The Lyric Theatre is near the end of the block on your right.

There is additional parking across the tracks in the lot by Sailfish circle.

FROM THE FLORIDA TURNPIKE:

- Exit at #133 and drive straight onto Martin Downs Blvd.
- Continue on Martin Downs Blvd approx 3 miles. Cross over Palm City Bridge.
- At light turn left onto Kanner Hwy (also called Hwy 76). A Hess Gas Station will be on your right.
- Continue on Kanner which turns into Colorado when you cross. U.S. Hwy 1.
- After crossing US 1, continue straight.
- Approx 1 mile you'll come to **Confusion Corner**. This is a traffic circle. Drive counterclockwise and turn right onto Flagler Ave. before you cross over the tracks again.
- Keeping the tracks on your left, drive north on Flagler.
- The Lyric Theatre is near the end of the block on your right.

There is additional parking across the tracks.

Tour Bus Parking is available within walking distance.

DO NOT USE MAPQUEST DIRECTIONS!

THEATER SPECIFICS

AUDITORIUM SEATING CAPACITY:

Upper Balcony	75
Lower Balcony	150
Orchestra	270 (including 8 handicap)
Box	<u>10</u>
Total	500 (seating chart included)

STAGE AND DELIVERY ENTRANCE/ LOADING:

59 SW Flagler Avenue
Stuart FL, 34994

HOSPITALITY:

Dressing Rooms:

Star Dressing room: SL toilet in room with Shower

Small rooms: 2 in basement, no plumbing

Chorus room: 1 in basement, no plumbing

Flex space backstage w/ Modular panels to create dressing rooms - (with bathroom facility, no shower)

TECHNICAL INFORMATION:

STAGING – Workable stage space – 34'd x 33' w

8- 4'x8' 4 way interlocking platforms

2- 4'x4' 4 way interlocking platforms (follow spot platforms)

RIGGING

3 - 35' battens dead hung at 21'6"

3 motorized battens (electrics) 1200lb cap. 1 FOH, 3' from PL, 8' from PL

Load Limit – 1200lbs per batten

Main Drape – Red 24oz Velour - opens from SL (does not guillotine)

Legs / Borders – 6 - 10'x 21'6" legs Black

2 - 5' x 40' borders Black

PROJECTION

DVD & Blu-ray player at FOH

Panasonic LCD Pt-L711XU Video projector @ 2200 Lumens.

Century Projection System 35mm

Century Heads

Kelmer Audio

Kelmer Automation

Kelmer Rewind

Kelmer Makeup Table

P&W Transport System

LIGHTING – (set in rep. config.)

Road Service Power

Panel B – 60 amp single phase used for sound only located SL

Panel LTG – 400 amp 3 phase fused panel, used lighting only

Shore power

60amp single phase circuit

Console – ETC 48/96

Dimming – 72 dimmers total, (48 ETC Sensor, 36 Leprechaun MX 2400)

LIGHTING INVENTORY:

2 – Chauvet 1200 House follow spots

16 – 18x10 watt quad LED Fixtures

16 - Dortron 26° Leko's

4 - Altman 3 circuit 15 cel cyc strips

2 - 15° Leko's

20 - Source 4 36 degrees

4 - Source 4 26 degrees

2 - Source 4 19 degrees

12- Altman 360q fixtures mounted on side boom poles(3 per boom)

26 – Chauvet Color-dash Par38 tri LED

4 - Elation 4 cell Strips (wash)

2 - Chauvet Color-dash Batten-tri LED

4- Chauvet Color-dash Batten 72 LED

PRODUCTION INTERCOM SYSTEM

4 BP200 beltpacks

1 BP-1 beltpacks

1 Main power station

1 dual headset

5 single headset

SOUND – Permanent FOH Mix Position

CONSOLES:

FOH – Yamaha M7 – Digital 40 Channel

Monitor - A&H 3300 GL series – 40x8x2

FOH System

8- GL10HPL Compact Line Array Module – Loaded w/ Eminece Speakers System Configuration	3-way, tri-amped
LF Subsystem	One 10 in neodymium, vented
LF/MF Subsystem	One 10 in neodymium, vented
HF Subsystem & Loading	Two x1.0 in exit/2.0 in voice coil compression drivers on 100 (h) x 10 (v) HF device
Operating Mode	Tri-amplified
Enclosure Material	9 and 13 ply Baltic birch plywood
Finish	Line-X
Connector	Two Neutrik NL8 Speakon

4- Double 18 Eminece Loaded sub cabinets

2 – JBL Side Fill

All Amping is QSC

MONITOR WEDGES

10 - Acoustic AM 2112

4 – Mackie Monitor 5's

MONITOR EQ'S

3 – DBX 2231

1 – DBX 1231

EFFECTS

1- Yamaha SPX 90

1- Presonus acp88

MICS & DI'S

2 - Shure Beta 87

4- Shure ULX Wireless Handheld Mics and 4 shure wI93 Lav packs

7 - Shure SM 58

7 - Shure SM 57

2 - Audix D 6 KICK Drum Mics

1 - Audix D 2 Snare Drum Mics

3 - Audix D 3 Tom Mics

1 – Audix D 4 Floor Tom Mic

2 Audix SCX 1 Condenser Mics

5 – AudioTechnia PZM's

4 – Behringer C1 Condenser mics

4 – OSP Mono DI's

2 – Behringer Active Mono DI's

1 – OSP Passive DI

2 – Rapco Passive DI's

***Any further information on sound or lighting system contact:
Bert Zimmerman at 772- 260-7343***

MISCELLANEOUS RESOURCES:

HARDWARE STORES:

Ace Hardware
975 SW Federal Hwy
Stuart, FL (1 mile)
772-287-3667

Home Depot
3030 SE Federal Hwy
Stuart, FL (3.5 miles)
(772)223-7216

HOTELS:

Best Western Downtown – 1.2 mi
1209 S. Federal Hwy
Stuart, FL
772-287-6200

The Clarion Inn – 1.1 mi
1200 S Federal Hwy
Stuart, FL
772-287-6900

Hutchinson Island Marriott Beach Resort –
4.8 mi
555 NE Ocean Blvd.
Stuart, FL 34996
772-225-3700
1-800-775-5936

Howard Johnson – 0.8 mi
950 S. Federal Hwy
Stuart, FL 34994
1-888-637-4861

LAUNDRY / DRY CLEANING (NO LAUNDRY FACILITIES ON SITE!):

Downtown Cleaners - same day turnaround 9am drop-off 4pm pickup
303 Colorado Ave.
Stuart, FL 34994
772 – 286 – 3418

Downtown Stuart Laundry (Publix plaza) – same day service depending on size of load
Coin Laundromat
736 S Federal Hwy
Stuart, FL 34994
772 – 286 - 1885

RESTAURANTS:

There are roughly a dozen restaurants within walking distance from the theatre including:

Black Marlin
53 SW Osceola St.
Stuart, FL 34994
(772) 286-3126

Jerry's La Famiglia
18 SE Seminole St.
Stuart, FL 34994
(772) 463-0059

Duffy's Sports Grill
1 SW Osceola St.
Stuart, FL 34994
(772) 221-4899

Key Lime Café and Grill
211 Colorado Ave.
Stuart, FL 34994
(772) 220-2400

The Gafford Grill
47 SW Flagler Ave
Stuart, FL 34994
(772) 221-9517

Mulligan's Beach House
61 SW Osceola St.
Stuart, FL 34994
(772) 288-1881

Osceola Street Café
26 SW Osceola Street
Stuart, FL 34994
(772) 283-6116

TAXI SERVICE

Stuart Taxi Service
772-334-1234

Martin Checker Cab
772-286-5113

Yellow Cab
772-334-1606

LIMOUSINE SERVICE

Elegant Limo Service
(15pass. vans, cars, limo)
800-772-8406

Cobblestone Limousine Service
(Towncar Sedans and Stretches)
772-286-2637

HOSPITAL

Martin Memorial Hospital
300 Hospital Ave Stuart (2 miles)
Main Line - 772-287-5200

MUSIC STORE

Shumacher Music
888 S Federal Hwy Stuart, Florida 34997
772-286-7474

LYRIC THEATRE SEATING CHART

Orchestra

19 18 17 16		AA	15 14 13 12 11 10 9 8 7 6 5		AA
21 20 19 18 17		BB	16 15 14 13 12 11 10 9 8 7 6		BB
21 20 19 18 17		CC	16 15 14 13 12 11 10 9 8 7 6		CC
23 22 21 20 19 18		DD	17 16 15 14 13 12 11 10 9 8 7		DD
25 24 23 22 21 20 19		EE	18 17 16 15 14 13 12 11 10 9 8		EE
25 24 23 22 21 20 19		FF	18 17 16 15 14 13 12 11 10 9 8		FF
25 24 23 22 21 20 19		GG	18 17 16 15 14 13 12 11 10 9 8		GG
25 24 23 22 21 20 19		HH	18 17 16 15 14 13 12 11 10 9 8		HH
25 24 23 22 21 20 19		JJ	18 17 16 15 14 13 12 11 10 9 8		JJ
25 24 23 22 21 20 19		KK	18 17 16 15 14 13 12 11 10 9 8		KK
25 24 23 22 21 20 19		LL	18 17 16 15 14 13 12 11 10 9 8		LL
25 24 23 22 21 20 19		MM	18 17 16 15 14 13 12 11 10 9 8		MM

Lower Balcony

13 11 9 7 5 3 1		A	112 111 110 109 108 107 106 105 104 103 102 101		A	2 4 6 8 10 12 14
15 13 11 9 7 5 3 1		B	112 111 110 109 108 107 106 105 104 103 102 101		B	2 4 6 8 10 12 14 16
19 17 15 13 11 9 7 5 3 1		C	112 111 110 109 108 107 106 105 104 103 102 101		C	2 4 6 8 10 12 14 16 18 20
19 17 15 13 11 9 7 5 3 1		D	112 111 110 109 108 107 106 105 104 103 102 101		D	2 4 6 8 10 12 14 16 18 20
		E	112 111 110 109 108 107 106 105 104 103 102 101		E	2 4
		F	112 111 110 109 108 107 106 105 104 103 102 101		F	2 4

Upper Balcony

G	19 17 15 13 11 9 7 5 3 1		114 113 112 111 110 109 108 107 106 105 104 103 102 101		G
H	19 17 15 13 11 9 7 5 3 1		114 113 112 111 110 109 108 107 106 105 104 103 102 101		H
J	126 125 124 123 122 121 120 119 118 117 116 115 114 113 112 111 110 109 108 107 106 105 104 103 102 101				J

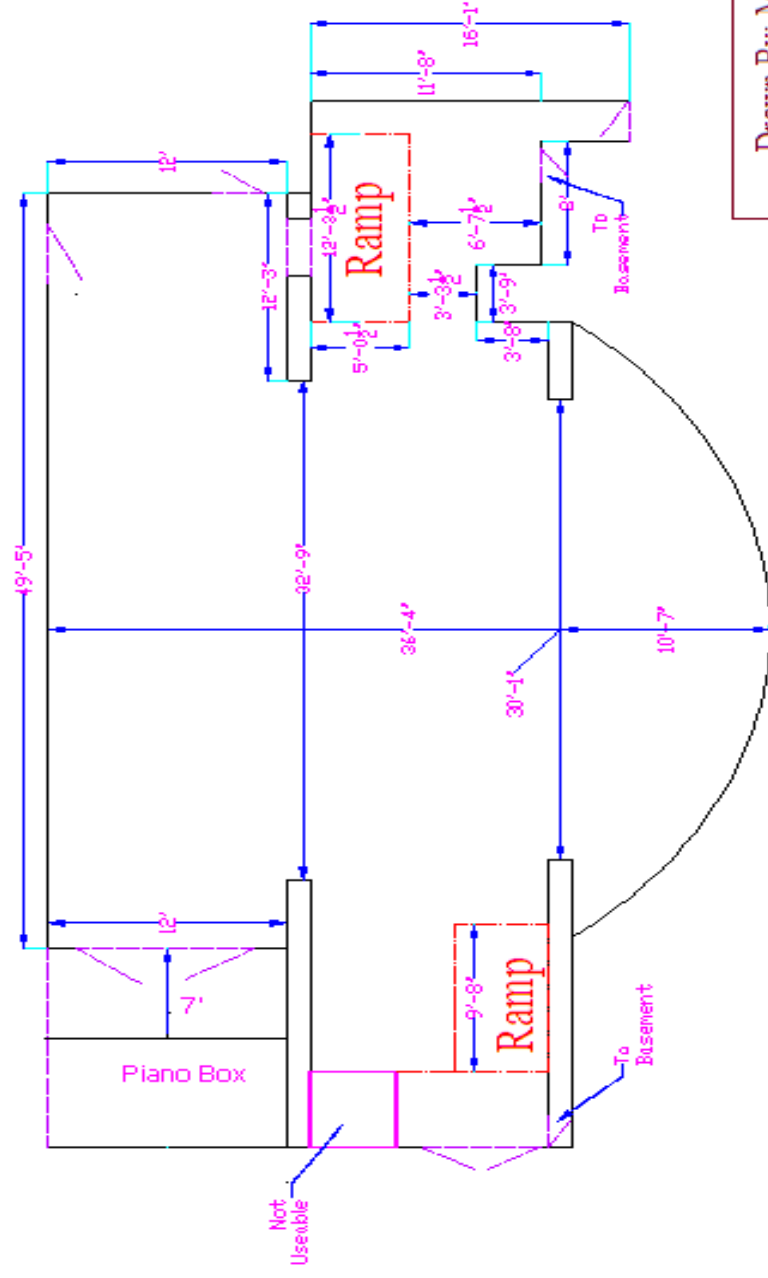

Drawn By: Maxfield Bishop
The Lyric Theater
Scale: 1" = 1'
Template: 01/01

Note: Only a 32'8" depth is available for use.